

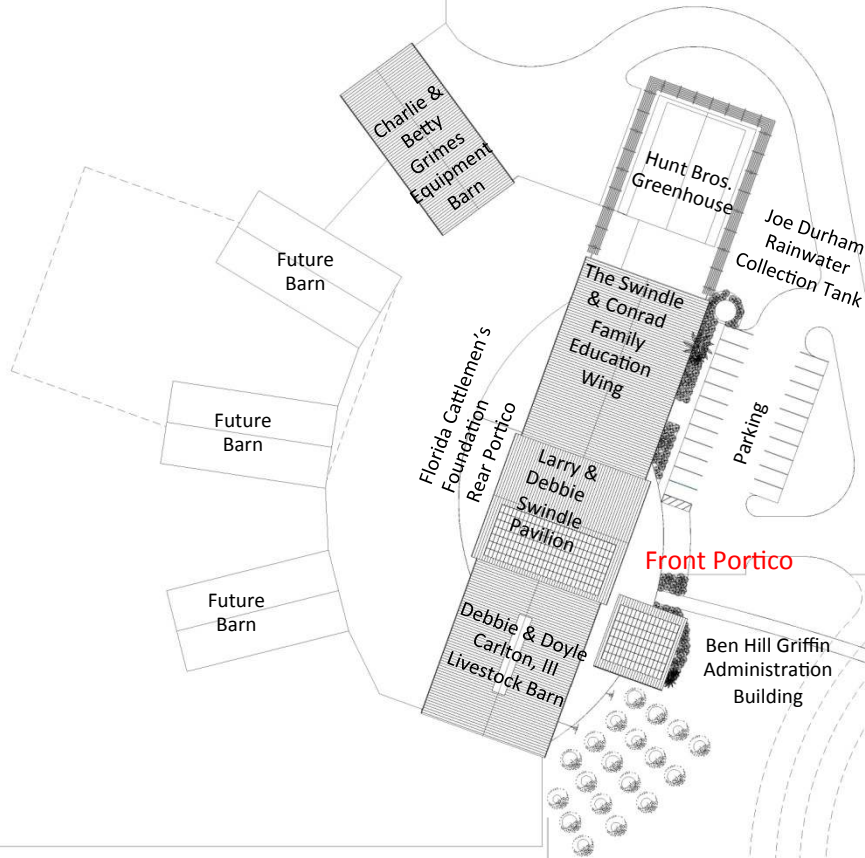

## Ed & Myrtle Lou Swindle Agriculture Complex – Warner University

The Ed & Myrtle Lou Swindle Agriculture Complex will be constructed utilizing environmentally friendly building practices. Some of the sustainable green building systems included in the Swindle Agriculture Complex will be wind mills and solar panels to be as energy self-sufficient as possible. A rainwater collection tank will provide water for irrigation and feeding purposes. This 38,000 sq. ft., \$2.8 million dollar complex was designed to enhance hands-on learning in order to graduate students skilled and ready to enter the Ag workforce. The complex was designed by Architect Scott Crews, and Ed Locke of Semco Construction will initiate the building phase once all funds have been raised, which will be in 2016.

# Ed & Myrtle Lou Swindle Agriculture Complex at Warner University



## Complex Exterior Naming Opportunities

- Administration Building Ben Hill Griffin, Inc.
- Livestock Barn Debbie & Doyle Carlton, III
- Pavilion Larry & Debbie Swindle
- Education Wing The Swindle & Conrad Family
- Equipment Barn Charlie & Betty Grimes
- Entrance Road/Driveway **\$150,000 Available**
- Rainwater Collection Tank Joe Durham
- Greenhouse Hunt Bros.
- Front Portico **\$ 50,000 Available**
- Rear Portico Fla. Cattlemen's Foundation

## **Entrance Road/Driveway**

## Major Equipment Naming Opportunities

- 4 WD Crew Cab Truck \$ 35,000 Available
- SMART board (1) \$ 14,000 Available
- 6 Welding Booths \$ 12,000 Available
- 15 Passenger Van \$ 26,000 Available
- Utility Vehicle \$ 13,000 Available
- 16' Livestock Trailer \$ 8,000 Available

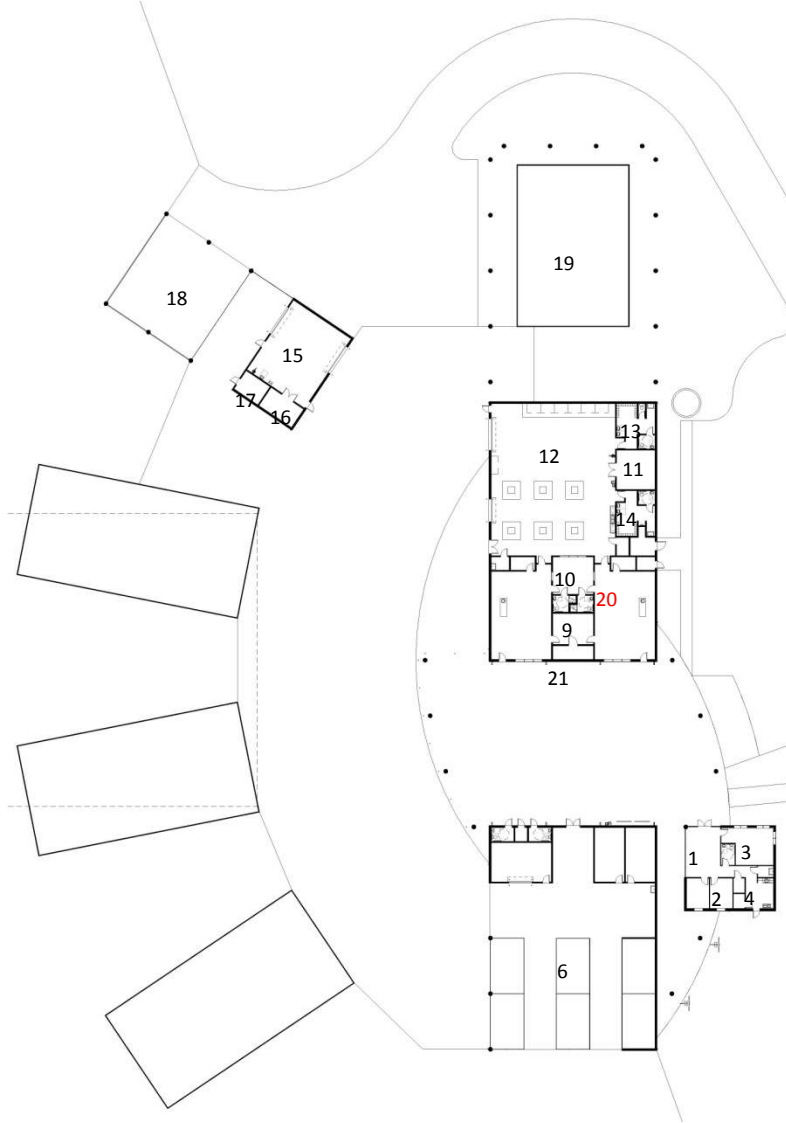

## Ag Complex Interior Naming Opportunities

### **Administration Building**

- |                         |                    |
|-------------------------|--------------------|
| 1. Reception            | Roger & Kay Ingley |
| 2. Faculty/Staff Office | Roger & Kay Ingley |
| 3. Conference Room      | Roger & Kay Ingley |
| 4. Office Work Room     | Roger & Kay Ingley |

### **Livestock Barn**

- |                      |   |
|----------------------|---|
| 5. Feed Storage Room | Lightsey Cattle Company                           |
| 6. Livestock Stalls  | Pat Wilson Inc./Crooked Lake Ranch                |
| 7. Tack Storage Room | #1 Bo & Emily Hobby<br>#2 Polk County Cattlewomen |

### **Educational Building**

- |                          |  |
|--------------------------|--|
| 8. Classrooms            | #1 Mildred W. & Doyle E. Carlton Jr.<br>#2 Wes & Darin Williamson/<br>Florida Cattlemen's Foundation |
| 9. Reference Library     | Ben Hill Griffin   |
| 10. Planning Room        | John & Laura Motis- Chemical Containers  |
| 11. Equipment Storage    | Ray & Karen Bassett  |
| 12. Agriculture Shop/Lab | Jahna Foundation   |
| 13. Locker Room – Women  | CRS Cattle Company   |
| 14. Locker Room – Men    | Charlie & Jane Stevens   |

### **Equipment Barn**

- |                            |                                |
|----------------------------|--------------------------------|
| 15. Machinery Storage      | Wayne Darr                     |
| 16. Tool Storage           | Lillian E. Bunker              |
| 17. Chemical Storage       | Lillian E. Bunker              |
| 18. Open Equipment Storage | Florida Farm Bureau Federation |

### **Greenhouse**

- |                      |                        |
|----------------------|------------------------|
| 19. Greenhouse       | Hunt Bros.             |
| 20. Catering Kitchen | \$40,000 Available     |
| 21. Digital Display  | Wes & Darin Williamson |

**Warner University – Agriculture Complex**



### **Ben Hill Griffin, Inc. Administration Building**

The Administration Building serves as the welcome center for prospective students and Ag community leaders. It houses faculty and staff offices, conference and work rooms, and the reception area.



### **Larry & Debbie Swindle Pavilion**

The Pavilion is a multi-purpose facility and will be utilized for outdoor classroom space, special events, community meetings, concerts, banquets, etc. It is the connector for all Ag Complex functions.

### **The Swindle & Conrad Family Education Wing**

The Education Wing is the hub of student activity for the Ag Program, housing a large machine shop, reference library, classrooms, and locker rooms for men and women.



### **Debbie & Doyle Carlton, III Livestock Barn**

The modern Livestock Barn features flexible dirt stalling, a concrete center walkway, wash area, tack and feed storage rooms, animal handling area, and direct access to the fenced field.